

GENERAL PURPOSE TYPE I TROUGH ENCLOSURES

Application

Designed to house electrical controls, instruments and components in areas that do not require oil, water and dust tight protection. For installation information, consult our installation manual at www.saginawcontrol.com.

Construction

- 0.048" and 0.060" carbon steel depending on its size.
- Spot weld construction.
- Standoffs provided for mounting optional subpanels.
- Removable cover.
- Black quarter turn latches.
- Latches are opened or closed with a screwdriver.
- Ground stud on door and body.
- Mounting holes in back of enclosure.
- Subpanel mounting hardware included.

Options

- Tamper-resistant quarter turns available.

Finish

ANSI-61 gray powder coated inside and out. Optional subpanels powder coated white.

IS8 Industry Standards

NEMA Type 1
UL Listed Type 1
CSA Type 1
IEC 60529 IP30

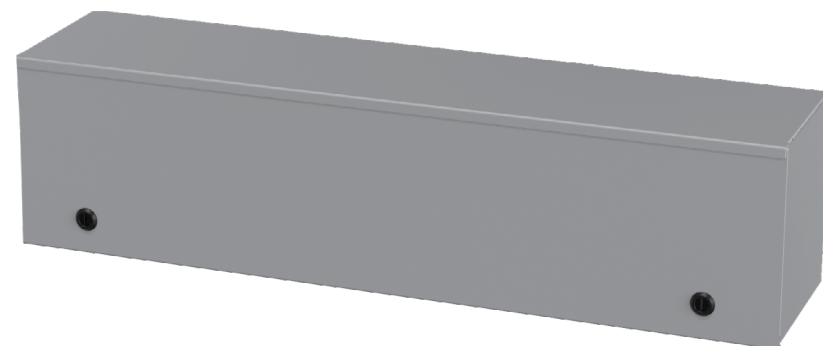

GENERAL PURPOSE TYPE I TROUGH ENCLOSURES TECHNICAL DATA

Enclosure Product Code N1					Subpanel (P2)		
Catalog No.	Height (A)	Width (B)	Depth (C)	Industry Standard	Catalog No.	Panel Height (D)	Panel Width (E)
SCE-L9N126LP	9.00	12.00	6.00	IS8	SCE-9N12MP	7.00	10.00
SCE-L9N128LP	9.00	12.00	8.00	IS8	SCE-9N12MP	7.00	10.00
SCE-L9N186LP	9.00	18.00	6.00	IS8	SCE-9N18MP	7.00	16.00
SCE-L9N188LP	9.00	18.00	8.00	IS8	SCE-9N18MP	7.00	16.00
SCE-L9N246LP	9.00	24.00	6.00	IS8	SCE-9N24MP	7.00	22.00
SCE-L9N248LP	9.00	24.00	8.00	IS8	SCE-9N24MP	7.00	22.00
SCE-L9N306LP	9.00	30.00	6.00	IS8	SCE-9N30MP	7.00	28.00
SCE-L9N308LP	9.00	30.00	8.00	IS8	SCE-9N30MP	7.00	28.00
SCE-L9N368LP	9.00	36.00	8.00	IS8	SCE-9N36MP	7.00	34.00
SCE-L9N366LP	9.00	36.00	6.00	IS8	SCE-9N36MP	7.00	34.00

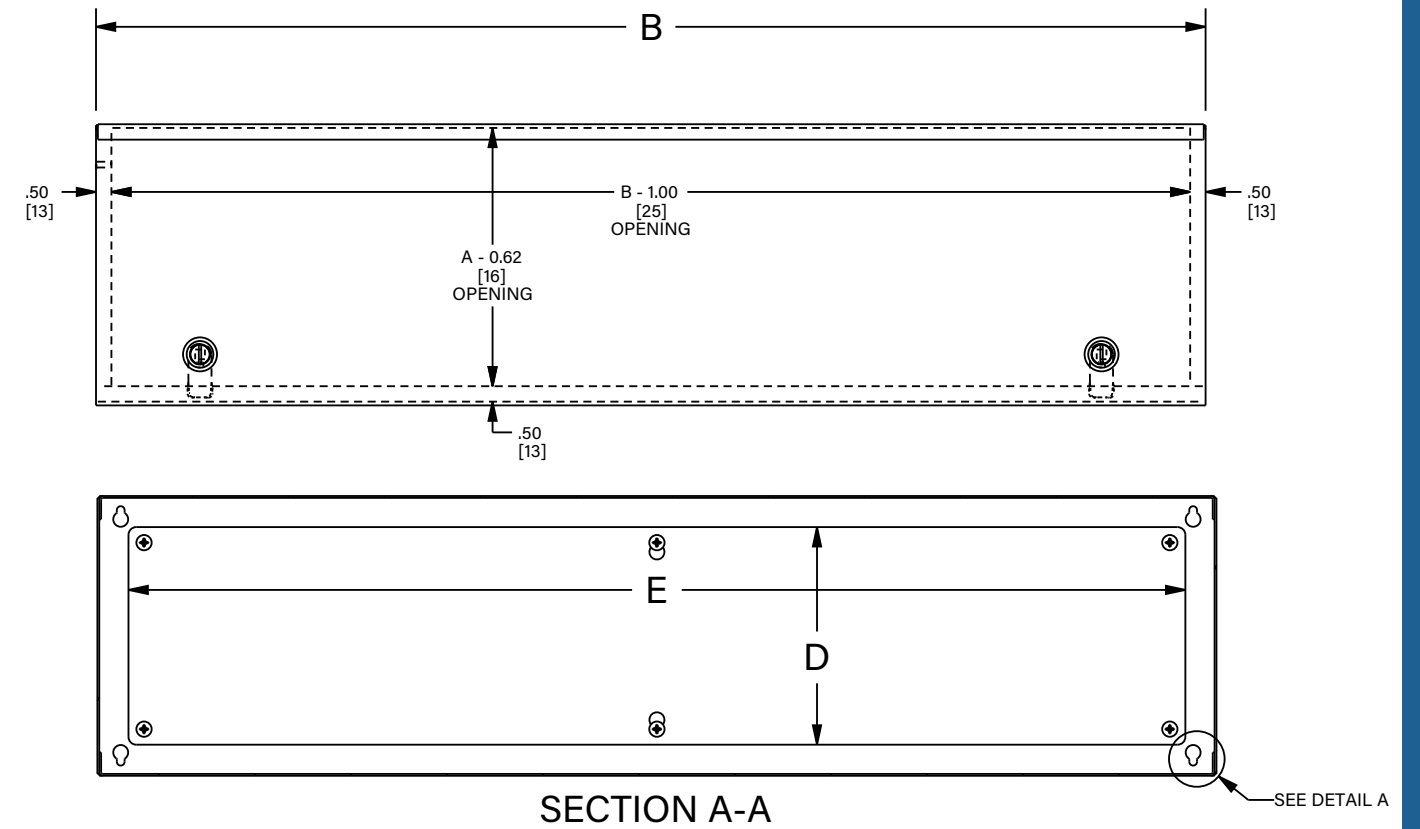

SECTION A-A

LATCH NOTE:
Enclosures ≤ 14.00 [356] in width require one latch centered on cover.

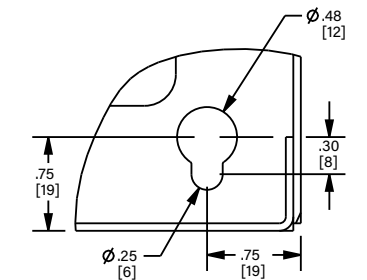
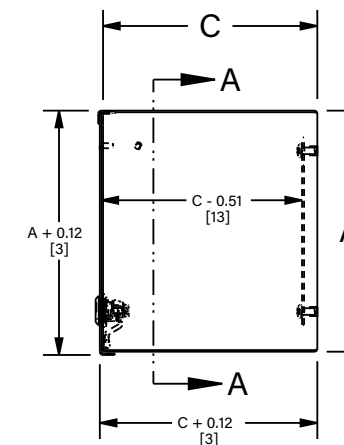

DETAIL A